

## DRAWINGS

ENTRY SECTION

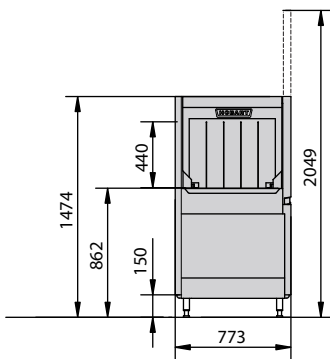

WASHING

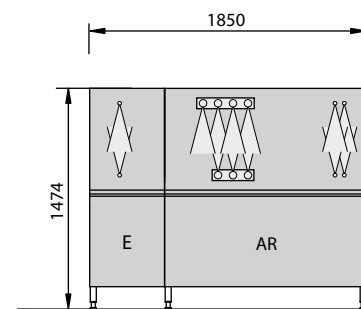
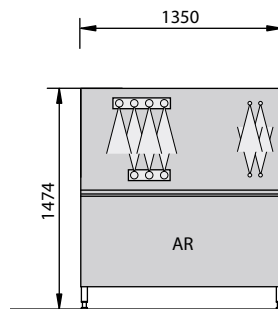

DRYING ZONE

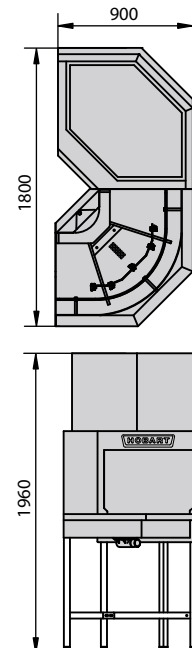
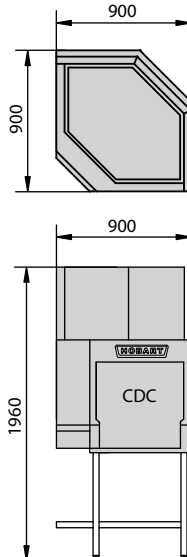
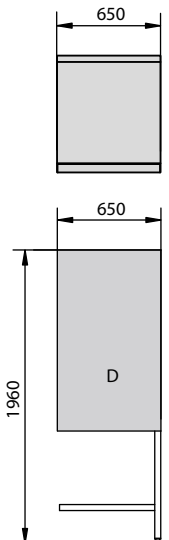

Loading height: 440 mm  
Loading width: 510 mm

## TECHNICAL DATA

RACKS Capacity maximum	CONVEYOR SPEED	WATER CONSUMPTION <sup>[1]</sup>		ENERGY CONSUMPTION kWh (connected load kW <sup>[2]</sup> ) with heat recovery	RECOMMENDED MODEL SELECTION	RECOMMENDED TOTAL LENGTH  in mm, without drying zone
		l/h	l/rack			
number/h	m/min					
135 / 200	1,13 / 1,67	230	1,15	24,8 (33,0)	CS-A-200	1.350
150 / 220	1,25 / 1,83	240	1,09	24,8 (33,0)	CS-E-A-220	1.850

<sup>[1]</sup> Using dual rinse

<sup>[2]</sup> Average value with an exemplary set of covers and type of business (dryer included); for standard version add 6 kW to the connected load